

Smart • Green • Inverter

Pure sine wave power frequency inverter



Low Consumption
High Efficiency

PREFACE

Thank you for choosing intelligent power frequency inverter, home inverter and online interactive series products produced by our company.

Please read this manual carefully, which will help you get the most full service life and service. Please strictly follow all the warnings and operation instructions in the manual and the machine and keep this book properly.

The installation/operation and maintenance of this series of products shall be carried out by trained and technical personnel, and the following requirements shall be followed:

1. Please confirm that the dc/ac voltage of the access product conforms to the nominal and rated working voltage of the product.
2. Please ensure that the dc input positive and negative poles of this product are correctly connected with the positive and negative electrodes of the battery, and not the reverse connection.
3. Please ensure that the connection wire between the product and the battery is as short as possible, the input and output wiring is correct and firm, and pay attention to avoid short circuit of the connection wire.
4. High voltage exists in the product. Non-electrical professionals are not allowed to open the case.

A car starting battery can provide a large current for a short period of time to start the engine, but it is not designed for continuous power consumption and is not suitable for deep cycle discharge. If you want to use some kind of electrical equipment continuously for a long time, you are recommended to equip with an additional set of batteries suitable for deep discharge, such as AGM or GEL batteries.

Statement: due to the continuous update and improvement of products and technologies, the content of this material may not fully conform to the actual products, please understand. If you need to inquire about the product update, please contact us.

Installation instructions	1
Install the matters needing attention	1
Panel shows	2
Inverter input and output wiring	3
Inverter wiring diagram	4
Maintenance and maintenance	6
Simple maintenance and repair methods	7
The appendix	8

1. Installation instructions

1. Unpacking inspection

Open the inverter packaging, please check the random attachment, the attachment includes a manual, warranty card, certificate. Check whether the inverter is damaged in transportation. If damaged or missing parts are found, please do not turn on the machine and inform the carrier and distributor.

Pay attention to

Please keep the packing cases and packing materials for future handling.

This series of products is heavy (see appendix), handle with care.

2 installation notes

1, the inverter must be placed in an area with good ventilation, away from water, flammable gas and corrosive agent.

2. The side panel fan inlet air hole shall be maintained, and the outlet air hole and the side box inlet air hole shall be unobstructed.

3, inverter of the ambient temperature shall be maintained between 0°C to 40°C .

4. If the machine is disassembled and installed at low temperature, there may be condensation of water droplets. It is necessary to wait for complete drying of the inside and outside of the machine before installation and use.

5. Please install the inverter near the mains power input socket or switch, so as to unplug the mains power input plug and cut off the power in case of emergency.

6. Do not connect the inverter output directly to the power supply.

Note:

Load and inverter connection, must first close the load, then wiring, and then turn on the load one by one

Connect the inverter to a special socket with over current protection device

All power sockets shall be connected to the protective ground end.

No matter whether the input power cord is inserted into the municipal socket or not, the output of the inverter may be charged. Turning off the inverter does not guarantee that the machine is not charged internally. If the inverter has no output, it must first turn off all Switch on and off the power supply.

When the motor, display, laser printer, and other inductive loads are connected, due to the high starting power of operation, the capacity of the inverter should be calculated based on the starting power. The starting power is generally twice of the rated power.

3.THE LCD PANEL SHOWS

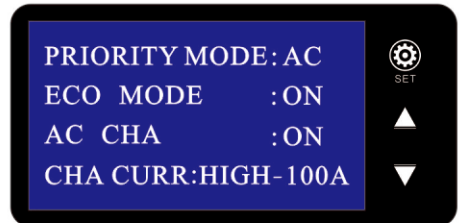
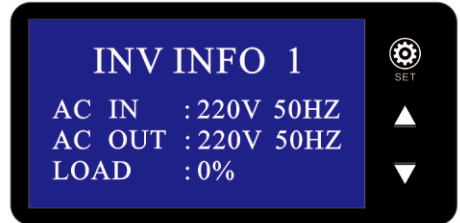
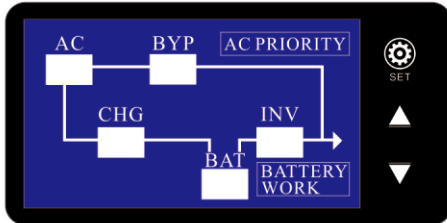

Note:

Press ▼ key to switch information, press ▲ return home page. Long press ⚙ key in 3 seconds. Set state. LCD screen no operation 5 seconds automatic off backlight (energy saving). Press again ⚙ Open Backlight

Energy saving (dormant) function, inverter working in battery mode and no load, 20 seconds after entering the state (off output) to achieve energy-saving effects, the load automatically open, normal use.

4. INVERTER INPUT/OUTPUT CONNECTIONS

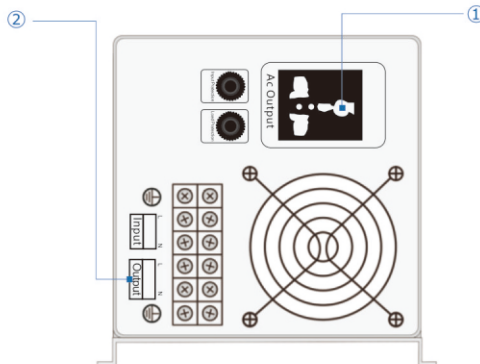
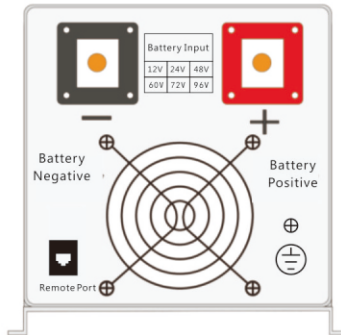

Side panels that

- ① Power is larger machine through the mains terminals connected the input and output load, universal ac output socket is only suitable for small power load under 1 of lw
- ② Ac inverter output 220 v, not with the utility grid.

5. INVERTER CONNECTION DIAGRAM THE

12V BATTERY WIRING DIAGRAM

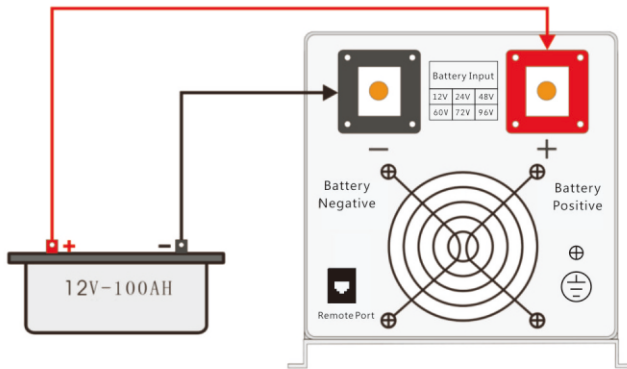

24V BATTERY WIRING DIAGRAM

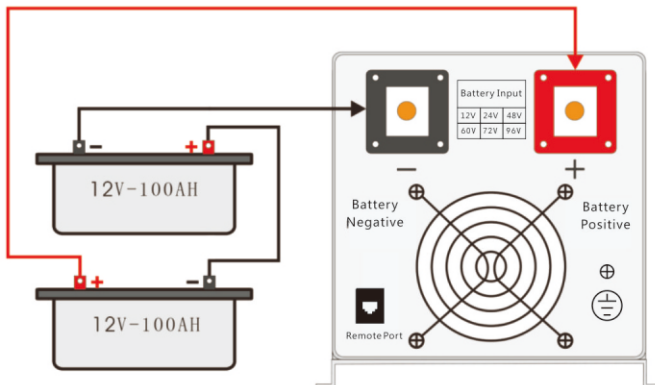

48 V BATTERY WIRING DIAGRAM

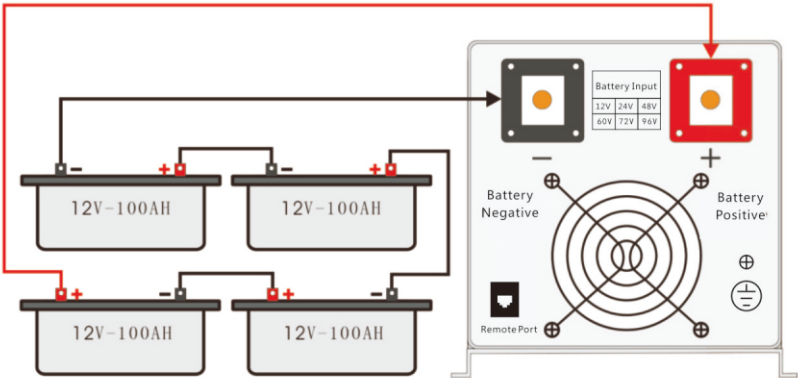

INPUT AND OUTPUT WIRING DIAGRAM

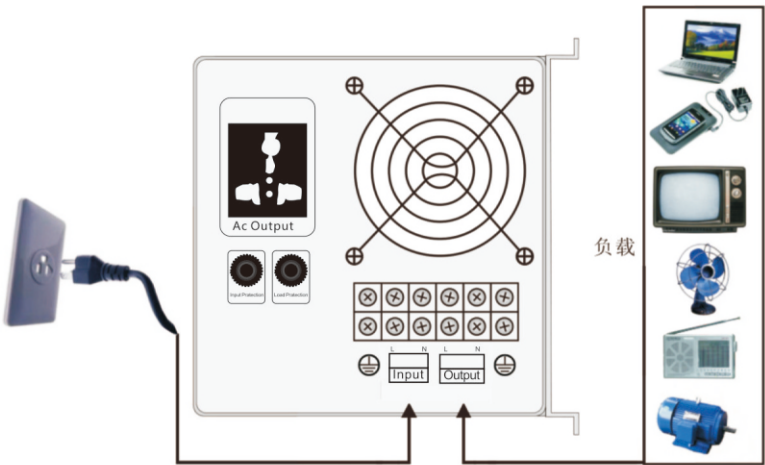

Note:

If connect a generator to complete the following steps to run:

- ① Start the engine, wait for after its running stability of generator output power inverter inputEnd (at this point to determine the inverter for no-load), then press the boot program start the inverter, the inverter starts, then each connected to the load.
- ② Recommendations to inverter two to three times the capacity of generator capacity.

6.Maintenance and maintenance

- ① This series inverter require little maintenance, the standard model of battery for regulating valve control type, low WeiHuXing, Only need to often keep charging for life expectancy.
- ② If long-term do not use the inverter, it is recommended that the charge once every two to three months.
- ③ Under normal circumstances, the service life of the battery for three years, if it is found that condition, you must early replacement, replace the battery, a professional must perform.
- ④ Battery should not be individual replacement, integral replacement battery supplier instructions should be strictly abided by during the normal every two to three months to charge the battery, discharge time, discharge is machine after charging, Charging time and standard machine shall not be less than 12 hours
- ⑤ .In the high temperature region, charge the battery every two months, discharge time, charging standard machine shall not be less than 12 hours at a time

Note:

- ① Replace the battery must be closed before inverter and from the mains, close the battery switch
- ② Take off the ring, watch metal objects
- ③ Use with insulated handles screwdriver, don't put the tools and other metal on the battery
- ④ Connected battery line, in a tiny spark joint belongs to the normal phenomenon, will not cause harm to the personal safety and inverter.
- ⑤ Never will the battery is negative sub or the reverse

7.Simple maintenance and repair methods

THE FAULTTHE	CAUSE OF THE PROBLEM	ELIMINATION METHOD
Fan does not turn	Machines have not reached 45 degrees Celsius temperature	Normal phenomenon, fan is intelligent control method
Terminal fever	Poor contact or loose	To tighten
Load off	The battery without electricity or overload	The battery or reduce some load
Can't open the machine	Cell line didn't answer	Check whether the cell line is connected or in again
Switch on the alarm	The battery without electricity or overload	The battery or reduce some load

THE APPENDIX

MODEL	ZY-AW102	ZY-AW152	ZY-AW202	ZY-AW302	ZY-AW402	ZY-AW502	ZY-AW602
RATED POWER	1000W	1500W	2000W	3000W	4000W	5000W	6000W
PEAK POWER	3000W	4500W	6000W	9000W	12000W	15000W	18000W
THE INPUT	(170-260)VAC						
FREQUENCY	45-65Hz						
VOLTAGE	AC220V+3% (THE BATTERY MODEL)						
FREQUENCY	50/60Hz+1% (THE BATTERY MODEL)						
OUTPUT WAVEFORM	SINE WAVE						
THE MACHINE EFFICIENCY	>85%						
THE BATTERY FORM	LEAD ACID, IRON, LITHIUM, COLLOID, THREE YUAN (18650) CAN BE CUSTOMIZED						
AN EXTERNAL BATTERY NOMINAL VOLTAGE	12/24/48VDC	12/24/48VDC				24/48VDC	
THE UTILITY MAXIMUM CHARGING CURRENT	80A(12VDC)、40A(24VDC)、20A(48VDC)						
TO PROTECT THE	OVERLOAD, SHORT CIRCUIT, OVER TEMPERATURE, HIGH VOLTAGE LOW VOLTAGE PROTECTION, HIGH AND LOW VOLTAGE PROTECTION ELECTRIC BATTERY						
TRANSFORMATION WAY	INTERACTIVE 5 MS (TYPICAL)						
OVERLOAD CAPACITY	110% ~ 120% MAINTENANCE MORE THAN 150% AFTER 60 SECONDS, 10 SECONDS						
COMMUNICATION INTERFACE		RS-232 (OPTIONAL)					
THE WORK ENVIRONMENT	THE TEMPERATURE		0 - 40°C				
	HUMIDITY		10%-90%				
CASE SIZE	L*W*H(mm)	480*220*180mm			660*220*180mm		
WEIGHT (NET WEIGHT)	(kg)	12kg	14.5kg	17kg	20kg	30kg	32kg
							35kg

THE ABOVE PARAMETERS ARE SUBJECT TO CHANGE WITHOUT PRIOR NOTICE.

Low Consumption
High Efficiency

This practical instructions mentioned in the product specification
or related information are subject to change without prior notice